

Outer and inner diameters of the tube should be as uniform as possible for the mandrel to be properly balanced.

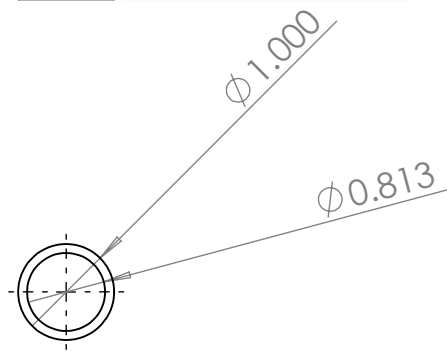

Inner diameter of the tube should be slightly smaller (~0.001 inches) than the inner diameter of the end plugs to allow for press-fitting.

UNLESS OTHERWISE SPECIFIED: DIMENSIONS ARE IN MILLIMETERS SURFACE FINISH: TOLERANCES: LINEAR: ANGULAR:		FINISH:		DEBUR AND BREAK SHARP EDGES		DO NOT SCALE DRAWING		REVISION	
	NAME	SIGNATURE	DATE			TITLE:			
DRAWN									
CHK'D									
APPV'D									
MFG						DWG NO.			
Q.A									
						Mandrel_Tube			
						SCALE:1:2		SHEET 1 OF 1	